

AIRPORT LAYOUT PLAN

JEFFERSON COUNTY INTERNATIONAL AIRPORT

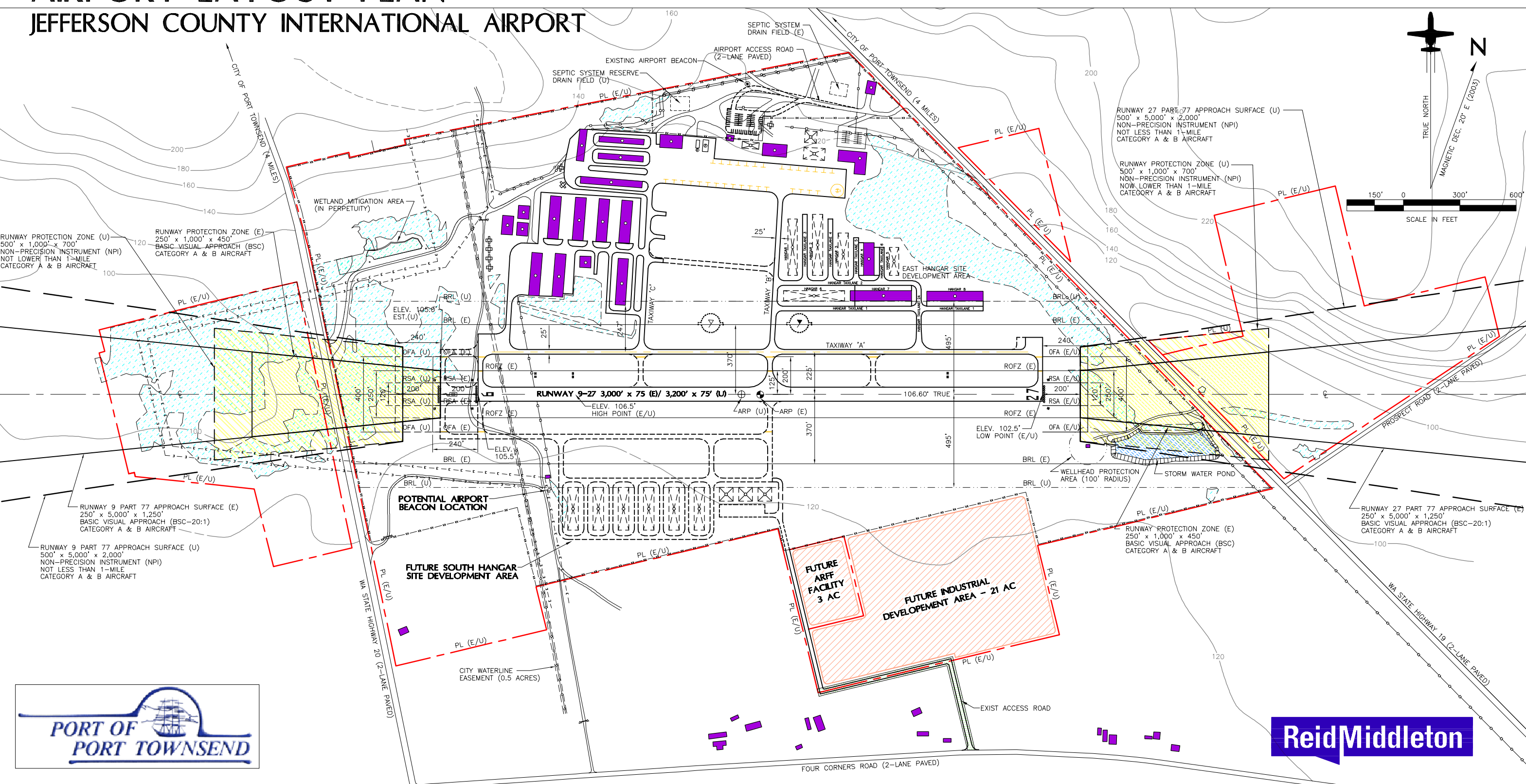
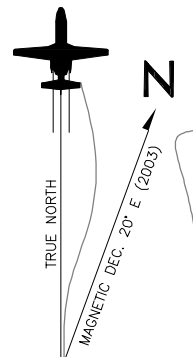

RUNWAY PROTECTION ZONE (U)
 500' x 1,000' x 700'
 NON-PRECISION INSTRUMENT (NPI)
 NOT LOWER THAN 1-MILE
 CATEGORY A & B AIRCRAFT

RUNWAY PROTECTION ZONE (E)
 250' x 1,000' x 450'
 BASIC VISUAL APPROACH (BSC)
 CATEGORY A & B AIRCRAFT

RUNWAY 27 PART 77 APPROACH SURFACE (U)
 500' x 5,000' x 2,000'
 NON-PRECISION INSTRUMENT (NPI)
 NOT LESS THAN 1-MILE
 CATEGORY A & B AIRCRAFT

RUNWAY PROTECTION ZONE (U)
 500' x 1,000' x 700'
 NON-PRECISION INSTRUMENT (NPI)
 NOT LOWER THAN 1-MILE
 CATEGORY A & B AIRCRAFT

RUNWAY 9 PART 77 APPROACH SURFACE (E)
 250' x 5,000' x 1,250'
 BASIC VISUAL APPROACH (BSC-20:1)
 CATEGORY A & B AIRCRAFT

RUNWAY 9 PART 77 APPROACH SURFACE (U)
 500' x 5,000' x 2,000'
 NON-PRECISION INSTRUMENT (NPI)
 NOT LESS THAN 1-MILE
 CATEGORY A & B AIRCRAFT

RUNWAY PROTECTION ZONE (E)
 250' x 1,000' x 450'
 BASIC VISUAL APPROACH (BSC)
 CATEGORY A & B AIRCRAFT

RUNWAY 27 PART 77 APPROACH SURFACE (E)
 250' x 5,000' x 1,250'
 BASIC VISUAL APPROACH (BSC-20:1)
 CATEGORY A & B AIRCRAFT



FOUR CORNERS ROAD (2-LANE PAVED)

WA STATE HIGHWAY 20 (2-LANE PAVED)

WA STATE HIGHWAY 19 (2-LANE PAVED)

CITY OF PORT TOWNSEND (4 MILES)

CITY OF PORT TOWNSEND (4 MILES)

FUTURE SOUTH HANGAR SITE DEVELOPMENT AREA

FUTURE ARFF FACILITY 3 AC

FUTURE INDUSTRIAL DEVELOPMENT AREA - 21 AC

WETLAND MITIGATION AREA (IN PERPETUITY)

POTENTIAL AIRPORT BEACON LOCATION

WELLHEAD PROTECTION AREA (100' RADIUS)

STORM WATER POND

SEPTIC SYSTEM DRAIN FIELD (E)

SEPTIC SYSTEM RESERVE DRAIN FIELD (U)

EXISTING AIRPORT BEACON

AIRPORT ACCESS ROAD (2-LANE PAVED)

EXIST ACCESS ROAD

CITY WATERLINE EASEMENT (0.5 ACRES)

RUNWAY 9-27 3,000' x 75' (E) / 3,200' x 75' (U)

RUNWAY 27

ELEV. 105.8' EST. (U)

ELEV. 106.5' HIGH POINT (E/U)

ELEV. 102.5' LOW POINT (E/U)

ELEV. 105.5

120

180

200

180

200

120

220

200

160

140

20

25'

25'

225'

120

120

120

120

140

20

25'

25'

125'

370'

370'

370'

370'

140

20

25'

25'

125'

370'

370'

370'

370'

140

20

25'

25'

125'

370'

370'

370'

370'

140

20

25'

25'

125'

370'

370'

370'

370'

140

20

25'

25'

125'

370'

370'

370'

370'

140

20

25'

25'

125'

370'

370'

370'

370'

140

20

25'

25'

125'

370'

370'

370'

370'

140

20

25'

25'

125'

370'

370'

370'

370'

140

20

25'

25'

125'

370'

370'

370'

370'

140

20

25'

25'

125'

370'

370'

370'

370'

140

20

25'

25'

125'

370'

370'

370'

370'

140

20

25'

25'

125'

370'

370'

370'

370'

140

20

25'

25'

125'

370'

370'

370'

370'

140

20

25'

25'

125'

370'

370'

370'

370'

140

20

25'

25'

125'

370'

370'

370'

370'

140

20

25'

25'

125'

370'

370'

370'

370'

140

20

25'

25'

125'

370'

370'

370'

370'

140

20

25'

25'

125'

370'

370'

370'

370'

140